

FABULOUS ENTRY

X-Treme Toyz installs Star Fab's "Smart Door" door stop kit on a '12 Jeep Wrangler JK

Text & Images by Mike Duval

Anyone who owns, or once owned a Jeep has most likely been smacked by the door swinging back when you least expect it. While there have been attempts to address this issue, most have fallen short in one regard or another.....until now. After the folks at Star Fabricating spent a great deal of research and development time working on the problem, they've come up with what might just be called the "Perfect Solution". Once installed, the "Smart Door" door stop works and looks just like the factory stops you see in most other vehicles.

The Star Fabricating kits come with everything you need and work on 2007 - current two & four door JK's. Our installation on a 2012 two door took about 1 hour to complete and can be accomplished by anyone with a minimal amount of mechanical skill and some tools.

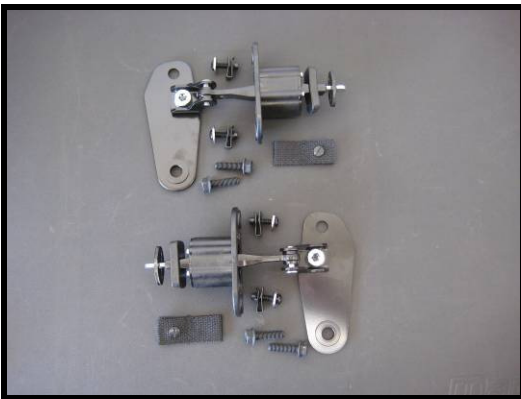

Kit Contents

Star Fabricating Front Installation:

1) Release the red lock tab on the door wiring connection, press the release tab and disconnect. Un-hook the fabric strap from the hook, fold the rear view mirror in, and swing the door open. Use a pad to protect the vehicle's body. A bungee cord or similar device is helpful to hold the door open (photo 1).



Photo 1

2) Remove the upper bolt on the lower door hinge. Place the hinge plate bracket and loosely secure with new longer bolt. Before tightening upper bolt, place a 13mm socket over the lower bolt to hold the bracket centered. Tighten upper bolt. (photos 2 & 3).



Photo 2



Photo 3

3) Remove lower factory bolt and replace with supplied longer bolt and centering washer (photo 4).



Photo 4

4) Cut out the supplied template. Locate the template on the door per the instructions and tape in place. Use extreme care when doing this step as it is critical for final location and fitment. Center punch the 3 hole locations (photos 5, 6 & 7).

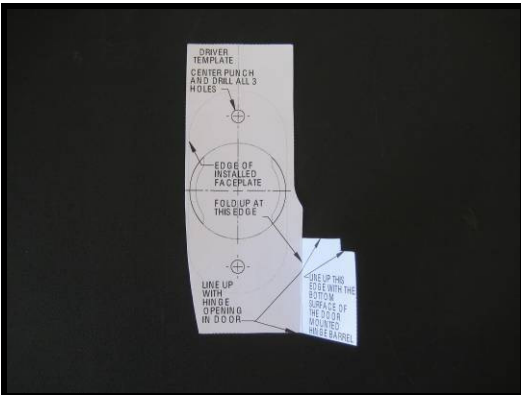

Photo 5

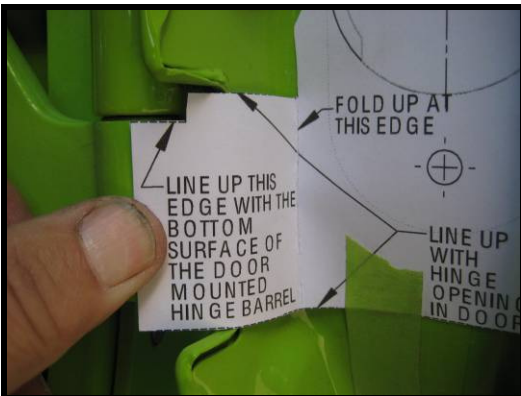

Photo 6



Photo 7

5) Drill a 1/8" pilot hole in the 3 center punched locations. Use a 2" hole saw to cut the center hole. Insert the door stop in the hole and confirm the alignment of the remaining 2 holes to be drilled. Remove door stop and drill remaining holes to 5/16". Use a file to clean up any rough edges (photos 8 & 9).



Photo 8



Photo 9

6) Clean up any shavings from door and apply touch-up paint to newly exposed metal areas. Install supplied clip nuts over 5/16" holes. The upper hole is double walled and installing the clip nut can be made easier by slightly expanding it prior to installation with a small punch or similar tool (photos 10 & 11).



Photo 10



Photo 11

7) Apply a light coat of silicone sealer to the back side of the door stop. Install the door stop with the "L" or "R" facing up, depending on which side of the vehicle you're working on. Attach with supplied allen bolts and flat washers (photo 12).



Photo 12

8) Attach the door stop to the hinge plate bracket with the supplied torx barrel nut (photo 13).



Photo 13

9) Follow the same steps for the opposite door.

10) The kit contains a pair of door strap extensions. These are installed by making a hole in the factory door strap and then attaching the extension with the supplied special screw assembly. The new hole in the factory strap can easily be made by heating a punch or similar diameter metal piece and piercing the nylon with the hot end (photos 14 & 15).

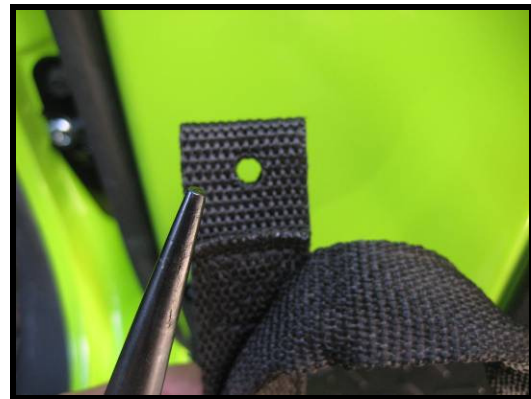

Photo 14



Photo 15

11) Re-connect the electrical and re-attach the modified door strap. Check that the door closes smoothly. If there is any binding, stop and re-adjust the stop to prevent damage to the mechanism (photo 16).



Photo 16

12) The rear door installation is much the same as the front. The rear doors retain the factory nylon door strap with no modifications. On some early models, there may be minor additional trimming of a protruding bracket once the 2" hole is cut.

As an option to the front door strap extensions described in step #10, Star Fabricating offers an optional full replacement extended door strap. The installation is straightforward and simple. You merely cut the factory strap off, and zip the replacement in place at the hook and door loop. The strap is also available in multiple colors to add some personalization to your rig! (photos 17-22).



Photo 17

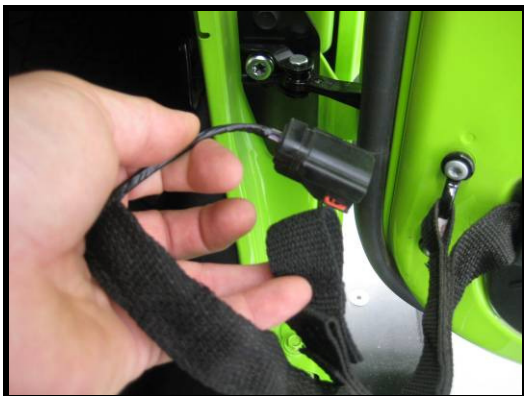

Photo 18



Photo19



Photo 20



Photo 21

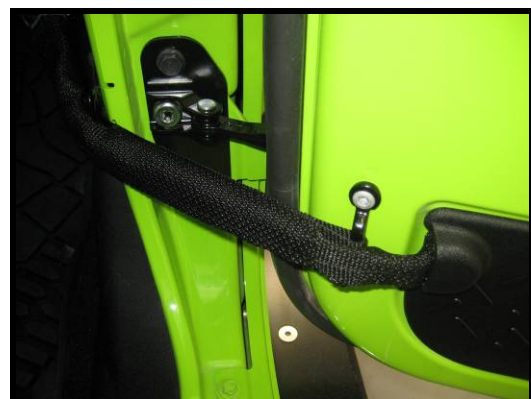

Photo 22

Sources:

Star Fabricating / Smart Door Stops
801-244-5859 www.starfabricating.com

X-Treme Toyz / Installation www.x-tremetoyz.com